

vtech[®]
Baby

User's Manual

Toot-Toot Animals

Toot-Toot Animals Train



© 2016 VTech
All rights reserved
Printed in China
91-003237-001TM

VTech understands that a child's needs and abilities change as they grow and with that in mind we develop our toys to teach and entertain at just the right level...

vtech Baby

Toys that will stimulate their interest in different textures, sounds and colours

I am...

...responding to colours, sounds and textures

...understanding cause and effect

...learning to touch, reach, grasp, sit-up, crawl and toddle

Birth-36 months



Pre-School

Interactive toys to develop their imagination and encourage language development

I want...

...to get ready for school by starting to learn the alphabet and counting

...my learning to be as fun, easy and exciting as can be

...to show my creativity with drawing and music so my whole brain develops

3-6 years



Electronic Learning Computers

Cool, aspirational and inspiring computers for curriculum related learning

I need...

...challenging activities that can keep pace with my growing mind

...intelligent technology that adapts to my level of learning

...National Curriculum based content to support what I'm learning at school

4-10 years



To learn more about this and other VTech® products, visit www.vtech.co.uk

INTRODUCTION

Thank you for purchasing the **VTech® Toot-Toot Animals Train!**

All aboard! Go on a journey with the **Toot-Toot Animals Train** by **VTech®**. Your little conductor can push and pull the train engine around as they watch the train carriages and the **SmartPoint®** hamster come to life.

THREE **SMARTPOINT®**
LOCATIONS

SEE-SAW

SPINNING WHEEL

SMARTPOINT®
HAMSTER

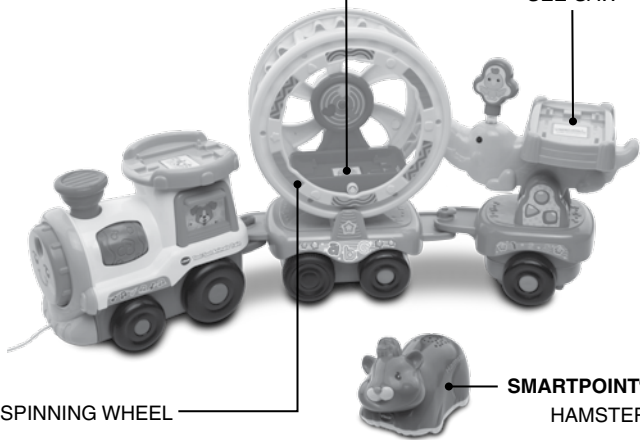

INCLUDED IN THIS PACKAGE

- One VTech® Toot-Toot Animals Train
- One SmartPoint® hamster
- One spinning wheel train carriage
- One see-saw train carriage
- Two sheets of labels
- User's manual

WARNING: All packing materials, such as tape, plastic sheets, packaging locks and tags are not part of this toy, and should be discarded for your child's safety.

NOTE: Please keep this user's manual as it contains important information.

Unlock the packaging locks:

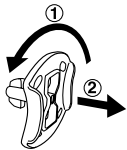

- ① Rotate the packaging lock anti-clockwise 90 degrees.
- ② Pull out and discard the packaging lock.

GETTING STARTED

BATTERY INSTALLATION - HAMSTER

1. Make sure the unit is turned **OFF**.
2. Locate the battery cover on the bottom of the hamster. Use a coin or a screwdriver to loosen the screw.
3. Install two new AAA (AM-4/LR03) batteries following the diagram inside the battery box. (The use of new alkaline batteries is recommended for maximum performance).
4. Replace the battery cover and tighten the screw to secure.

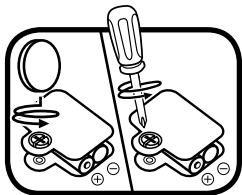

BATTERY NOTICE

- Use new alkaline batteries for maximum performance.
- Use only batteries of the same or equivalent type as recommended.
- Do not mix different types of batteries: alkaline, standard (carbon-zinc) or rechargeable (Ni-Cd, Ni-Mh), or new and used batteries.
- Do not use damaged batteries.
- Insert batteries with the correct polarity.
- Do not short-circuit the battery terminals.
- Remove exhausted batteries from the toy.
- Remove batteries during long periods of non-use.
- Do not dispose of batteries in fire.
- Do not charge non-rechargeable batteries.
- Remove rechargeable batteries from the toy before charging (if removable).
- Rechargeable batteries are only to be charged under adult supervision.

Disposal of batteries and product



The crossed-out wheellie bin symbols on products and batteries, or on their respective packaging, indicates they must not be disposed of in domestic waste as they contain substances that can be damaging to the environment and human health.



The chemical symbols Hg, Cd or Pb, where marked, indicate that the battery contains more than the specified value of mercury (Hg), cadmium (Cd) or lead (Pb) set out in Battery Directive (2006/66/EC).

The solid bar indicates that the product was placed on the market after 13th August, 2005.

Help protect the environment by disposing of your product or batteries responsibly.

For more information, please visit:

www.recycle-more.co.uk

www.recyclenow.com

Stick the labels to the play set securely as indicated below:

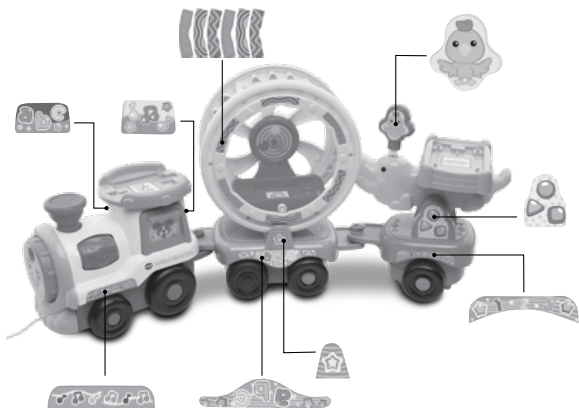

PRODUCT FEATURES - HAMSTER

1. ON/OFF SWITCH

To turn the unit **ON**, slide the **ON/OFF SWITCH** to the **ON** (⏻) position. To turn the unit **OFF**, slide the **ON/OFF SWITCH** to the **OFF** (●) position.

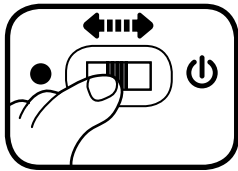

2. AUTOMATIC SHUT-OFF

To preserve battery life, the **VTech® Toot-Toot Animals** hamster will automatically power-down after approximately 50 seconds without input. The unit can be turned on again by pressing the light-up button, pushing the hamster quickly or triggering a **SmartPoint®** location.

Note: This product is in Try Me mode in the packaging. After opening the package, turn the animal **OFF** and **ON** again to proceed with normal play. If the unit repeatedly powers down quickly or the light-up press button fades out, we suggest changing the batteries.

ACTIVITIES - HAMSTER

1. Slide the **ON/OFF SWITCH** to the **ON** position to turn the unit **ON**. You will hear a fun sound, a song and a phrase. The light will flash with the sounds.

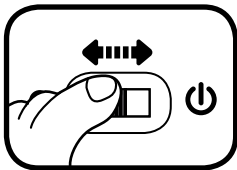

2. Press the **LIGHT-UP BUTTON** to hear fun sounds, sing-along songs and phrases. The light will flash with the sounds.



3. Push the hamster to hear fun sounds and melodies. While a melody is playing, push the hamster again to add fun sounds on top of the melody. The light will flash with the sounds.

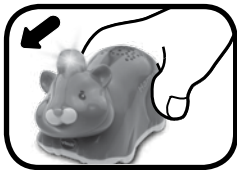

4. For added fun, the hamster interacts with the **Toot-Toot Animals Train** and all **VTech® Toot-Toot Animals** play sets (each sold separately). Simply place or roll the hamster over one of the three **SmartPoint®** locations on the **Toot-Toot Animals Train** to see the light flash and to hear greetings, fun sounds, short tunes and sing-along songs. You can also play with the hamster on **Toot-Toot Animals** tracks (each sold separately).



ACTIVITIES - Toot-Toot Animals Train

1. Place the hamster or any **SmartPoint**® animal (each sold separately) on any of the three **SmartPoint**® locations to trigger fun sounds, songs or phrases.
2. Place up to three **Toot-Toot Animals** characters on the train and its train carriages, and pull them around.
3. Use the different manipulative features on the train and its train carriages for role-play fun. Turn the smiling face, press the chimney, spin the spinning wheel and more!
4. Connect all the train carriages and push or pull the train to watch as the mechanical features on the two carriages begin to move. You can also watch the spinning wheel spin and the see-saw go up and down on its own.
5. To convert the unit from a push toy to a pull toy, remove the pull cord from the storage compartment on the bottom of the **Toot-Toot Animals Train**. For your child's safety, we suggest you store the pull cord in the compartment until your child is walking and to supervise your child when playing with the pull cord.

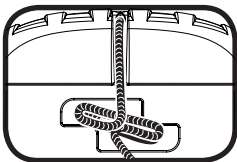
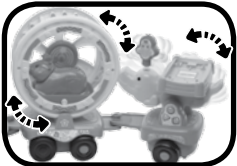
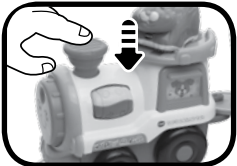
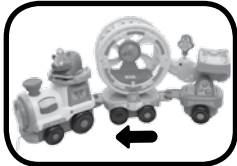

CARE & MAINTENANCE

1. Keep the unit clean by wiping it with a slightly damp cloth.
2. Keep the unit out of direct sunlight and away from any direct heat.
3. Remove the batteries when the unit will not be in use for an extended period of time.
4. Do not drop the unit on hard surfaces and do not expose the unit to moisture or water.

TROUBLESHOOTING

If for some reason the program/activity stops working or malfunctions, please follow these steps:

1. Please turn the unit **OFF**.
2. Interrupt the power supply by removing the batteries.
3. Let the unit stand for a few minutes, then replace the batteries.
4. Turn the unit **ON**. The unit should now be ready to play again.
5. If the product still does not work, replace with a new set of batteries.

If the problem persists, please call our Consumer Services Department on 01235 546810 (from UK) or +44 1235 546810 (outside UK) and a service representative will be happy to help you.

IMPORTANT NOTE:

Creating and developing **VTech®** products is accompanied by a responsibility that we take very seriously. We make every effort to ensure the accuracy of the information, which forms the value of our products. However, errors sometimes can occur. It is important for you to know that we stand behind our products and encourage you to call our Consumer Services Department on 01235 546810 (from UK) or +44 1235 546810 (outside UK), with any problems and/or suggestions that you might have. A service representative will be happy to help you.





PRODUCT REGISTRATION

Visit www.vtech.co.uk/clubvtech/login
to register your VTech product

By joining the VTech Club you can also enter competitions, find out about news and events, seek expert advice for parents and let your kids play fun learning games and activities.



PRODUCT WARRANTY

Thank you for choosing this quality product from VTech. We hope it will bring many hours of entertainment, imaginative play and learning.

1. The product detailed above is covered by a one year warranty from the date of purchase, against any defects in materials or workmanship.
2. The product may be returned to the place of purchase. Alternatively the product can be returned to VTech Electronics Europe plc (see address below), with proof of purchase, without proof of purchase no replacement will be provided.
3. VTech Electronics Europe plc will examine the product and if it is found to be defective due to faulty materials or workmanship, will replace the product at their discretion.
4. If the product covered by this warranty is damaged due to misuse, modification or unauthorised repair, or because of faulty batteries, battery discharge or incorrect electrical connections, then this warranty becomes void.
5. This warranty is personal to the original purchaser and is not transferable.
6. Breakages to the LCD screen are not covered by the warranty.
7. Returns to VTech Electronics Europe plc should include a cheque or postal order for £1.50 towards the cost of return postage and packaging.
8. Products returned to VTech Electronics Europe plc, should be addressed as follows and packed carefully to avoid damage in transit (Please do not include batteries or adaptor). Please include details of the fault together with your name and address.
9. To keep an online record of your warranty, please register your product online at www.vtech.co.uk/warranty

VTech Electronics EU PLC, c/o XPO Logistics, Warehouse 350, Cat & Fiddle Lane, West Hallam, DE7 6HE

THIS WARRANTY IS OFFERED AS AN EXTRA BENEFIT AND DOES NOT AFFECT CONSUMERS' STATUTORY RIGHTS.

This warranty is valid for the UK and Eire only. For products purchased outside the UK and Eire, please contact your local distributor or place of purchase.

